

# WINTER PROMO Catalog 2019-2020



Competitor Products and Trademarks: In addition to Haldex's own products, Haldex remanufactures the products of various other companies in the industry ("competitor products") including the following brands: Carrier, Bendix, Ford, Caterpillar, Mack, Cummins, Detroit Diesel, CAT, WABCO, Meritor, Sealco, Primus, Voyager, Kenworth, Navistar, Peterbilt, Mack, GMC (General Motors), Chevy, Dodge, Ford, DDC, Isuzu, MAN, Mercedes, Navistar, Perkins, Renault, Crane, Delco, Leece- Neville, Motorola, Horton, Gold Top, Dayton, Sprague, Trico, Thermo-King, TRW, Saginaw, Hobourn/Eaton, Vickers, Fruehauf, Dana, Dana Spicer, Spicer, Dexter, Vibra Seal, SKF, NOVA Bus, New Flyer Bus, Easy-Stop, LIPE, Lucas Girling, and Eaton. All trade names and trademarks associated with those competitor products referenced in this catalog are the property of the respective competitors or their licensors. Haldex's use of the competitor names and marks is solely for the purpose of describing the origin of the products or intended use. None of these competitors are affiliated with Haldex, nor are we, our products or this catalog sponsored by them.

## **Important Notice**

The products described within this literature, including without limitation, product features, specifications, designs, availability and pricing are subject to change by Haldex and its subsidiaries at any time without notice. This document and other information from Haldex, its subsidiaries and authorized distributors provide product and/or system options for further investigation by users having technical expertise. It is important that you analyze all aspects of your application and review the information concerning the product or system, in the current literature or catalog. Due to the variety of operating conditions and applications for these products or systems, the user, through their own analysis and testing, is solely responsible for making the final selection of the products and systems and assuring that all performance, safety and warning requirements are met.

<b>Table of Contents</b> .....	1
<b>Part Number To Page Number Index</b> .....	2
<b>Haldex Air Dryers</b>	
DRYest® Air Dryer .....	3
PURest® Air Dryer.....	4
Pure Air Plus™ Air Dryer .....	5
Pure Air™ Air Dryer .....	6
<b>Haldex Service Kits</b>	
DRYest® Service Kits.....	7-8
PURest® Service Kits.....	9
Pure Air Plus™ Service Kits.....	10
Pure Air™/Pure Air Plus™ Heater Kits .....	11
Pure Air™ Service Kits .....	12
Aerofiner II and III Service Kits.....	13
<b>WABCO Air Dryers/Service Kits</b>	
WABCO® SS1200 .....	14
WABCO® SS1200 Repair Kits .....	15
<b>Bendix® Air Dryers/Service Kits</b>	
Bendix® AD-2 .....	16
Bendix® AD-4.....	17
Bendix® AD-9.....	18
Bendix® AD-IP.....	19
Bendix® AD-IS.....	20
Bendix® AD-SP .....	21
Bendix® End Cover Assembly .....	22
Bendix® Repair Kits.....	23
<b>Competitive Cartridges</b> .....	24
<b>Haldex CONSEP® Condenser/Separator</b> .....	25
CONSEP® Service Kits.....	26
<b>Haldex Automatic Drain Valve (ADV)</b> .....	27
Automatic Drain Valve (ADV) Service Kits.....	27
<b>Haldex Reservoir Purge Valve (RPV)</b> .....	28
<b>Haldex Alcohol Evaporator</b> .....	28

Copyright 2019  
Haldex Brake Products Corporation  
10930 N. Pomona Ave.  
Kansas City, MO 64153

All rights reserved.  
Materials may only be reproduced with written permission of Haldex.

# Air Treatment Products

# Part Number to Page Number Index

Type "O" = OEM Part Number. Type "S" = Service Part Number.

Part #	Type	Page #	Part #	Type	Page #	Part #	Type	Page #	Part #	Type	Page #	Part #	Type	Page #
031005609	S	24	287298K	S	23	65454X	S	22	DA34100	S	4	N4261	O	3
101900MKX	S	24	300074E	S	10	65499X	S	18	DA34105	S	4	N4261A	O	3
101900X	S	24	300074E	O	10	65605X	S	18	DA34110	S	4	N4261B	O	3
102642	S	12	400158	O	12	65624K	S	24	DA34160	S	4	N4261C	O	3
102642	O	12	40010019	S	27	65647WX	S	18	DA34165	S	4	N4261D	O	3
102657K	S	23	41010021	S	27	65647X	S	18	DA34200	S	4	RN60	S	12
102760A	O	10	41071327	S	27	65650	S	18	DA34310	S	4	RN60A	S	12
103818K	S	23	41092749	S	26	65650N	S	18	DA35100	S	3	RN60D	S	12
103879K	S	23	41092750	S	26	65654X	S	22	DA35105	S	3	RN60E	S	12
103980K	S	22	41176281	S	27	800404K	S	23	DA35110	S	3	RN60F	S	12
104027K	S	23	41176282	S	27	800973CX	S	21	DA35115	S	3	RN60G	S	9
104358MKX	S	24	41178240	S	26	800973X	S	21	DA35200	S	3	RN60G	S	10
104358X	S	24	411-78240	O	26	950011K	S	24	DA35205	S	3	RN60G	S	12
107695K	S	23	41189454	S	27	950013K	S	15	DA35210	S	3	RN60H	S	12
107794CX	S	24	41189455	S	27	950014K	S	15	DA35215	S	3	RN60J	S	12
107794MKX	S	24	41210026	S	25	950015K	S	15	DA35220	S	3	RN60K	S	12
107794RX	S	24	41210029	S	25	950016K	S	15	DQ6011	S	11	RN60N	S	11
107794X	S	24	41277322	S	26	950017K	S	15	DQ6012	S	11	RN60P	S	11
107796	S	24	41290364	S	26	955079CRX	S	14	DQ6013	S	9	RN60S	S	12
107798K	S	23	42123048	S	28	955079CX	S	14	DQ6013	S	11	RN94	S	13
107800K	S	23	47010001	S	8	955205	S	14	DQ6014	S	9	RN94	O	13
109477CX	S	19	47110015	S	7	955205CX	S	14	DQ6014	S	11	RN950	S	13
109477RX	S	19	47110020	S	7	955205K	S	14	DQ6020	S	10	RN951	S	13
109477X	S	19	47110021	S	7	955205KRX	S	14	DQ6023	S	9	RN954	S	13
109478X	S	19	47110022	S	7	955205KX	S	14	DQ6023	S	10	RN969	S	13
109493CX	S	24	47110024	S	8	955205RX	S	14	DQ6024	S	10	RN969	O	13
109493RX	S	24	471-10024	O	8	955205X	S	14	DQ6025	S	12	RN970	S	13
109493X	S	24	47177343	S	7	955206CX	S	14	DQ6026	S	10	RN970	O	13
109494K	S	23	47177434	S	7	955206KCX	S	14	DQ6027	S	9	RN973	S	13
109495K	S	23	47177442	S	7	955206X	S	14	DQ6027	S	10	RN973	O	13
109498K	S	23	47178106	S	7	955300CX	S	14	DQ6028	S	10	RN978	S	13
109569K	S	23	47178199	S	7	955300X	S	14	DQ6031	S	10	S4341003100	S	7
109578K	S	23	47178223	S	7	955315CX	S	14	DQ6032	S	10	S4341003100	S	15
109579K	S	23	47178964	S	7	955315X	S	14	DQ6036	S	10			
109685CX	S	18	47187348	S	7	A39219	S	28	DQ6037	S	9			
109685HX	S	18	471-87348	O	7	A48373	S	28	DQ6037	S	10			
109685X	S	18	47189189	S	7	A72420	S	28	DQ6050	S	9			
109686X	S	23	47190361	S	7	A72421	S	28	DQ6051	S	9			
109687X	S	18	5000709X	S	19	A72422	S	28	DQ6052	S	9			
109688HX	S	18	5000985X	S	19	A75962	S	28	DQ6053	S	9			
109688X	S	18	5001247K	S	23	AD48373	O	28	DQ6054	S	7			
109689CX	S	18	5003547K	S	23	AD75962	O	28	DQ6054	S	9			
109689X	S	18	5004050CX	S	20	AE72420	O	28	K022105K	S	23			
109869K	S	23	5004050X	S	20	AE72421	O	28	KN21200	S	28			
109871K	S	23	5004338K	S	23	AE72422	O	28	KN33000	S	6			
109991	S	21	5004341X	S	23	AE73494	S	28	KN33002	S	6			
109991CX	S	21	5004342X	S	23	AE73494	O	28	KN33010	S	6			
109991X	S	21	5005037K	S	23	CART224	S	24	N4244	O	6			
109992CX	S	21	5005893K	S	23	D300074	S	12	N4244A	O	6			
109992X	S	21	5008414K	S	24	D330000	S	12	N4245	O	6			
109993K	S	23	5010696CX	S	20	D331000	S	10	N4253AA	O	4			
109994K	S	24	5010696X	S	20	DA33100BX	S	5	N4253AB	O	4			
109995K	S	23	5018227X	S	19	DA33100X	S	5	N4253AD	O	4			
201160B	O	10	65041X	S	17	DA33110X	S	5	N4253AH	O	4			
28675RX	S	22	65044X	S	22	DA33115	S	9	N4253J	O	4			
286875X	S	22	65224	S	18	DA33115	S	10	N4254AB	O	4			
286876X	S	22	65224X	S	18	DA33125	S	10	N4260	O	3			
286934X	S	16	65225	S	18	DA33140X	S	5	N4260A	O	3			
286936X	S	16	65228X	S	18	DA33200X	S	5	N4260B	O	3			
287053K	S	23	65231X	S	22	DA33240X	S	5	N4260C	O	3			

## Haldex DRYest®



### Features:

- Extended Service Air Dryer for System Purge Application
- Multi-Treatment Cartridge employs five stages of cleaning to ensure dry system air
- Integrated turbo protection
- Built-in heater prevents freezing and damage to the dryer
- Extra compact size allows for easy installation anywhere
- Integrated governor option increases dryer performance and reduces application costs
- Integrated muffler allows for superior, quiet operation

### Specifications:

Stages of Drying	5
Inlet Temperature	-40°F to +170°F
Maximum Working Pressure	170 PSI
Safety Relief Pressure	150 PSI
Heater 12V, 24V	90W
Drying Capacity	5.8 SCF
Desiccant Cartridge	3.5 lbs.
Assembly Weight	13.5 lbs.
Governor Cut-Out	125 ± 5 PSI
Maximum Inlet Airflow	35 SCFM
Pressure Drop	35 SCFM/175 psi = 3 PSI
Regeneration Valve	Silencer
System Purge Drain	
Turbo Protection	35 PSI Inlet

### Notes:

- 1) Fits in 12" x 6-3/4" x 6-3/4" Envelope; includes 1/2" clearance needed for desiccant cartridge change.

Service Part No.	Product Description	Heater Voltage	System Regeneration	Integrated Governor	Notes	OEM Part No.
DA35100	DRYest Air Dryer	12V	Yes	No	-	N4260
DA35105	DRYest Air Dryer	24V	Yes	No	-	N4260A
DA35110	DRYest Air Dryer	12V	No	No	For use with external purge tank.	N4260B
DA35115	DRYest Air Dryer	24V	No	No	For use with external purge tank.	N4260C
DA35200	DRYest Air Dryer	12V	Yes	Yes	-	N4261
DA35205	DRYest Air Dryer	24V	Yes	Yes	-	N4261A
DA35210	DRYest Air Dryer	12V	No	Yes	For use with external purge tank.	N4261B
DA35215	DRYest Air Dryer	24V	No	Yes	For use with external purge tank.	N4261C
DA35220	DRYest Air Dryer	None	No	Yes	For use with external purge tank.	N4261D

## Haldex PURest®



### Features:

- Multi-Treatment Cartridge employs five stages of cleaning ensure dry system air
- Integrated turbo protection
- Built-in heater prevents freezing and damage to the dryer
- Universal mounting bracket eases retro-fit installations. Fits Pure Air Plus, DRYest, AD Type and SS Type Air Dryer bolt patterns.

### Specifications:

Stages of Drying	5
Internal Purge Volume	210 cu. in.
Inlet Air Temperature Range	-40° F to 175° F
Maximum Working Pressure	150 PSI
Safety Relief Pressure	175 PSI
Secondary Press. Protection	235 PSI
Heater 12V, 24V	95W
Flow Capacity	34 SCFM
Desiccant Cartridge	3.5 lbs.
Assembly Weight	22.0 lbs.
Integrated Turbo Protection	2 PSI @ 15 SCFM/120 PSI Pressure Drop

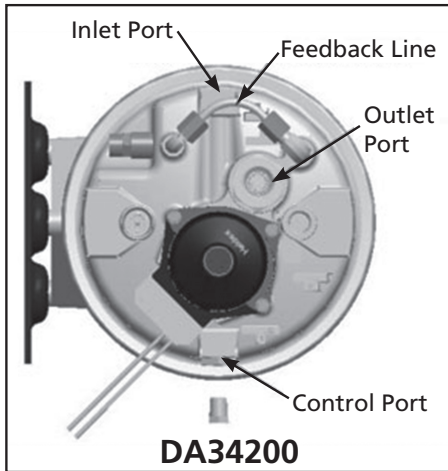

### Notes:

- 1) Fits in 17 3/4" x 9 3/4" x 9 1/2" Envelope. This includes 1/2" clearance for desiccant cartridge change.
- 2) **DA34200** for Holset "E" Type Compressor Application.

Service Part No.	Product Description	Heater Voltage	Notes	OEM Part No.
DA34100	PURest Air Dryer	12V	90 W	N4253AA
DA34105	PURest Air Dryer	None	With Bracket, Inlet Port – Left	N4253AD
DA34110	PURest Air Dryer	24V	With Bracket, Inlet Port – Left	N4253AB
DA34160	PURest Air Dryer	12V	Without Bracket, Inlet Port – Left	N4253J
DA34165	PURest Air Dryer	12V	With 200 PSI Pressure Relief With Bracket, Inlet Port – Left	N4253AH
DA34200	PURest Air Dryer	12V	With "Econ" Valve With Bracket, Inlet Port –Left	–
DA34310	PURest Air Dryer	24V	With Bracket, Inlet Port – Right	N4254AB

## Haldex Pure Air Plus™



### Features:

- Compact and lightweight
- Built-in Turbo-Saver™ Valve reduces engine horsepower loss for improved fuel mileage
- Replaceable Coalescing Filter features advanced state-of-the-art filtration system to remove even the smallest oil particles and contaminants
- Fast, easy, economical on-vehicle servicing

### Specifications:

Length	15.1"
Maximum Width	9.31"
Heater	95W Thermostatic
Primary Material	Aluminum
Drying Method	Coalescence/Desiccant
Burst Rating	300 PSI
Mounting	Bracket with Stainless Steel Clampband
Mounting Position	Vertical
Max. Compressor Capacity	25 SCFM

### Notes:

- 1) Mounting hardware only included with **DA33100BX**.
- 2) Pure Air Plus™ Repair Kits and Replacement Parts listed later in this section.

Service Part No.	Product Description	Heater Voltage	Canister Size	Inlet Port	Outlet Port	Governor Port	Exhaust Port	Approx. Weight	Notes	Core Group
DA33100BX	Remanufactured Pure Air Plus Air Dryer	12V	2 lbs.	1/2"	1/2"	1/8"	1" Hose	22.0 lbs.	Standard, Mounting Bracket Inc.	330
DA33100X	Remanufactured Pure Air Plus Air Dryer	12V	2 lbs.	1/2"	1/2"	1/8"	1" Hose	21.9 lbs.	Standard	330
DA33110X	Remanufactured Pure Air Plus Air Dryer	24V	2 lbs.	1/2"	1/2"	1/8"	1" Hose	22.5 lbs.	Standard	330
DA33140X	Remanufactured Pure Air Plus Air Dryer	12V	3 lbs.	1/2"	1/2"	1/8"	1" Hose	27.1 lbs.	Heavy Duty Holset	330
DA33200X	Remanufactured Pure Air Plus Air Dryer	12V	2 lbs.	1/2"	1/2"	1/8"	1" Hose	22.6 lbs.	Standard for Applications with Holset "E" Type Compressor	330
DA33240X	Remanufactured Pure Air Plus Air Dryer	12V	3 lbs.	1/2"	1/2"	1/8"	1" Hose	28.0 lbs.	Standard for Applications with Holset "E" Type Compressor	330

## Haldex Pure Air™



**Features:**

- Triple action - cools, filters and dries the air
- May be mounted vertically or horizontally
- Serviceable from either end

**Specifications:**

Length	18.25"
Maximum Width	7.49"
Heater	60W Thermostatic
Primary Material	Aluminum
Drying Method	Coalescence/Desiccant
Burst Rating	500 PSI
Mounting Position	Vertical or Horizontal

**Notes:**

- 2) Pure Air™ Repair Kits and Replacement Parts listed later in this section.

Service Part No.	Product Description	Heater Voltage	Inlet Port	Outlet Port	Governor Port	Exhaust Port	Approx. Weight	OEM Part No.	Core Group
KN33000	Pure Air Air Dryer	12V	1/2"	1/2"	1/8"	1" Hose	26.5 lbs.	N4244	-
KN33002	Pure Air Air Dryer Compact Size	12V	1/2"	1/2"	1/8"	1" Hose	18.6 lbs.	N4245	-
KN33010	Pure Air Air Dryer	24V	1/2"	1/2"	1/8"	1" Hose	25.9 lbs.	N4244A	-



## Haldex DRYest® Service Kits



Service Part No.	Product Description	Notes
47110015	Packard Electrical Connector - DRYest	With 12" pigtail
47110020	Heater Kit 12 V - DRYest	With pigtail and splice connectors
47110021	Heater Kit 24 V - DRYest	With pigtail and splice connectors
47110022	Check Valve Assembly Kit - DRYest	-
47177343	Valve Kit Assembly - DRYest	With integrated governor (125 PSI)
47177434	Regeneration Valve - DRYest	-
47177442	Valve Kit Assembly - DRYest	Without integrated governor
47178106	Turbo Protection Valve - DRYest	External
47178199	Heater 24 V - DRYest	Heater Only
47178223	Heater 12 V - DRYest	Heater Only
47178964	MTC Desiccant Cartridge Kit - DRYest	Includes mounting bolts, o-ring, bolt, anti-seize lubricant and installation instructions
47187348	Valve Kit Assembly - DRYest	With internal governor (150 PSI) OEM Part No. 471-87348
47189189	Turbo Protection Valve Kit - DRYest	Integrated
47190361	Safety Valve - DRYest	11 Bar
DQ6054	O-Ring Kit - DRYest, Purest®	10 Pack
S4341003100	Pressure Control Check Valve	-

**Haldex DRYest® Purge Tank Kit**



Service Part No.	Product Description	Hose	Fittings	Tank Size	Application
47010001	Purge Tank Kit for DRYest	6'	Brass	4.5 Liter	DA35100, DA35105, DA35110, DA35115, DA35200, DA35205, DA35210, DA35215, DA35220

**Haldex DRYest® Air Dryer Valve Cap**



Service Part No.	Product Description	Length	Width	Depth	Weight	Application	OEM Part No.
47110024	White Plastic Valve Cap for DRYest	1/2"	1-1/2"	3/4"	0.2 lbs.	Fits under MTC cartridge in DRYest Air Dryer	471-10024

## Haldex PURest® Service Kits



Service Part No.	Product Description	Notes
DA33115	Purge Assembly Kit - Pure Air Plus™, PURest	–
DQ6013	12 V Heater Kit - Pure Air Plus, PURest	12 Volt – For dryers date coded after 8/97; includes Heater 102655DP
DQ6014	24 V Heater Kit - Pure Air Plus, PURest	24 Volt – For dryers date coded after 8/97; includes Heater 102655DT
DQ6023	Purge Shield Kit - Pure Air Plus, PURest	–
DQ6027	Extended Purge Kit (Tank) - Pure Air Plus, PURest	Includes tube and fitting assembly (2), 1/4" drain valve (1), 3/8" pipe plug (1), air reservoir (1)
DQ6037	Differential Feedback Check Valve Kit - Pure Air Plus, PURest	–
DQ6050	MTC Desiccant Cartridge Kit - PURest	–
DQ6051	Universal Mounting Bracket	–
DQ6052	Turbo Protection Valve Kit - PURest	–
DQ6053	Lower Housing Repair Kit - PURest	–
DQ6054	O-Ring Kit - PURest, DRYest® Cartridge	10 Pack
RN60G	One-Way Check Valve Kit - Pure Air™, Pure Air Plus, PURest	Outlet check valve kit

## Haldex Pure Air Plus™ Service Kits



Service Part No.	Product Description	Notes
300074E	Mounting Bracket - Pure Air Plus	OEM Part No. 300074E
D331000	Nipple - Pure Air Plus	Pre-1996 Models
DA33115	Purge Assembly Kit - Pure Air Plus, PURest®	-
DA33125	3 lb. Desiccant Cartridge Only - Pure Air Plus	Heavy Duty OEM Part No. 201160B
DQ6020	Lower Housing Repair Kit - Pure Air Plus	Includes purge, turbo-saver™, one-way check valve assemblies
DQ6023	Purge Shield Kit - Pure Air Plus, PURest	-
DQ6024	Clamp Band Kit - Pure Air Plus	OEM Part No. 102760A
DQ6026	General Service Kit - Pure Air Plus	Includes desiccant cartridge, coalescing filter, relief valve, purge shield, associated hardware
DQ6027	Extended Purge Kit (Tank) - Pure Air Plus, PURest	Includes tube and fitting assembly (2), 1/4" drain valve (1), 3/8" pipe plug (1), air reservoir (1)
DQ6028	Heavy Duty Kit (Cartridge and Tank) - Pure Air Plus	Includes tube and fitting assembly (2), 1/4" drain valve (1), 3/8" pipe plug (1), air reservoir (1), desiccant canister (1), o-ring (1), 1/4 oz. grease (1)
DQ6031	Turbo Kit - Pure Air Plus	-
DQ6032	Coalescing Filter Kit - Pure Air Plus	Includes coalescing filter (1), small o-ring (1), desiccant canister gasket (new style)
DQ6036	2 lb. Desiccant Cartridge Only - Pure Air Plus	6 1/2" tall
DQ6037	Differential Feedback Check Valve Kit - Pure Air Plus, PURest	-
RN60G	One-Way Check Valve Kit - Pure Air™, Pure Air Plus, PURest	Outlet check valve kit

## Haldex Pure Air™ and Pure Air Plus™ Heater Kits



When RN60N and RN60P are used on pre-1989 production, the lower cover assembly must also be replaced.

Service Part No.	Product Description	Notes
DQ6011	12V Heater Kit - Pure Air Plus	12 Volt – For dryers date coded prior to 9/97; includes Heater #102655FE
DQ6012	24V Heater Kit - Pure Air Plus	24 Volt – For dryers date coded prior to 9/97; includes Heater #102655FF
DQ6013	12V Heater Kit - Pure Air Plus, PURest®	12 Volt – For dryers date coded after 8/97; includes Heater #102655DP
DQ6014	24V Heater Kit - Pure Air Plus, PURest	24 Volt – For dryers date coded after 8/97; includes Heater #102655DT
RN60N	12V Heater Kit - Pure Air™	Includes 12 Volt heater assembly, heater element cover, screw
RN60P	24V Heater Kit - Pure Air	Includes 24 Volt heater assembly, heater element cover, screw

## Haldex Pure Air™ Service Kits



Service Part No.	Product Description	Notes
102642	Retainer (Cover) - Pure Air	OEM Part No. 102642
D300074	Aluminum Bracket - Pure Air	Includes aluminum bracket (1) - two brackets required to mount
D330000	Canister - Pure Air	OEM Part No. 400158
DQ6025	Elbow Kit with Boot - Pure Air	-
RN60	Minor Service Kit - Pure Air	-
RN60A	Major Kit - Pure Air	Includes filter (1), desiccant bag (1), o-rings (8), check valve seal (1), purge valve seal (1), silicone grease (2)
RN60D	Lower Cover Assembly - Pure Air	12 Volt
RN60E	Lower Cover Assembly - Pure Air	24 Volt
RN60F	Purge Valve Kit - Pure Air	-
RN60G	One-Way Check Valve Kit - Pure Air, Pure Air Plus™, PURest®	Outlet check valve kit
RN60H	Minor Kit - Compact Pure Air	-
RN60J	Major Kit - Compact Pure Air	-
RN60K	Elbow Kit - Pure Air	Includes screws (3)
RN60S	Top Cover Assembly - Pure Air	-

## Haldex Aerofiner II and III Service Kits

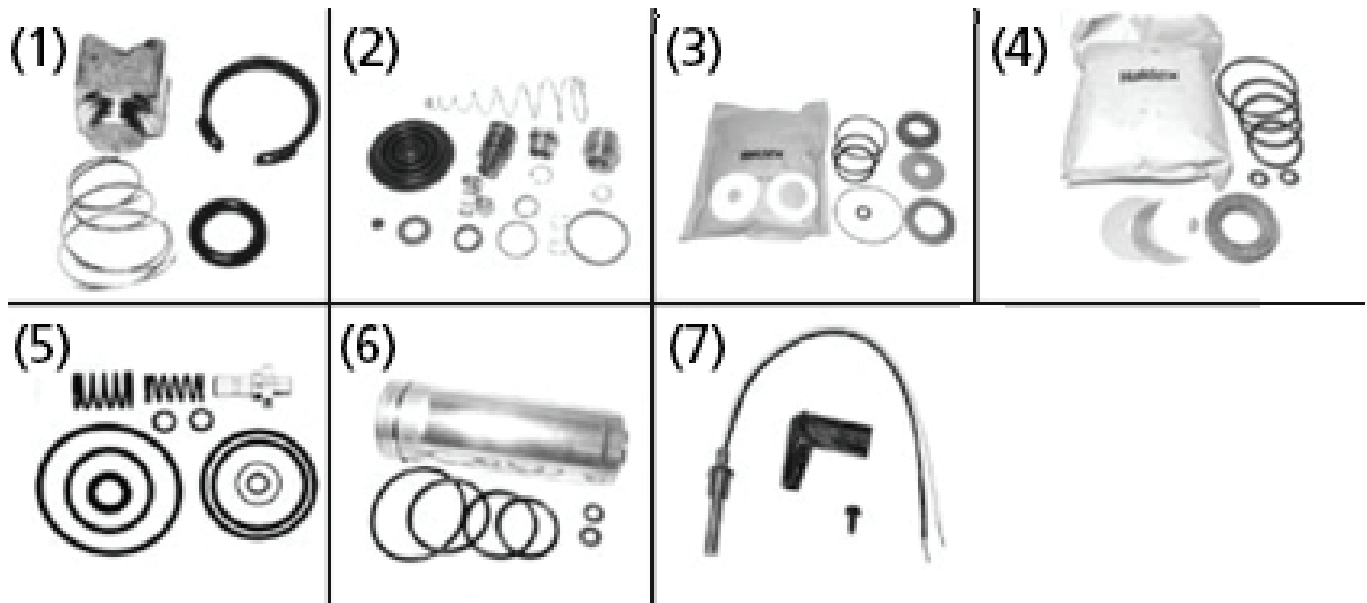

Service Part No.	Product Description	Application	OEM Part No.	Pic. No.
RN94	Check Valve Repair Kit - Aerofiner II	KN33550, KN33540, KN33530, KN33520, KN33510, KN33500	RN94	1
RN950	Check Valve Repair Kit - Aerofiner III	KN33600, KN33610, KN33620, KN33630, KN33640, KN33650, KN33660, KN33670, KN33680, KN33690	-	2
RN951	Desiccant Recharge Kit - Aerofiner III	KN33600, KN33610, KN33620, KN33630, KN33640, KN33650, KN33660, KN33670, KN33680, KN33690	-	3
RN954	Top Service Mounting Clamp Kit - Aerofiner III	KN33600, KN33620, KN33640, KN33660, KN33680	-	-
RN969	Bulk Recharge Kit - Aerofiner II	KN33550, KN33540, KN33530, KN33520, KN33510, KN33500	RN969	4
RN970	Purge Valve Repair Kit - Aerofiner II	KN33550, KN33540, KN33530, KN33520, KN33510, KN33500	RN970	5
RN973	Recharge Canister Kit - Aerofiner II	KN33550, KN33540, KN33530, KN33520, KN33510, KN33500	RN973	6
RN978	Standard Heater with Thermostat 24V, 35W, 1.5 Amps - Aerofiner II	KN33540	-	7

## WABCO SS1200

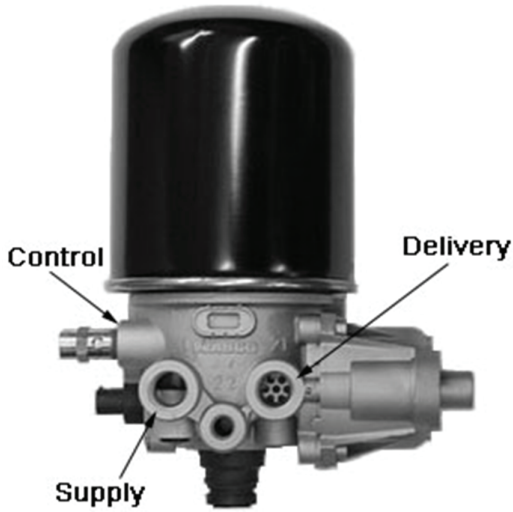

### Features:

- Lightweight
- Compact 1200 Series
- Replaceable spin-on cartridge
- Metri-pack type heater connector

### Specifications:

Height	11.2"
Supply	1/2" - 14 NPT
Delivery	1/2" - 14 NPT
Control	1/4" - 18 FPT

### Notes:

- 1) **955300X, 955315X** do not have a regeneration valve.
- 2) **955300X, 955315X, 955300CX, 955315CX** require an external purge tank which is not supplied.

Service Part No.	Product Description	MFG Part No.	Heater Voltage	Approx. Weight	Core Group
955079CRX	Remanufactured WABCO SS1200 with Coalescing Filter	-	12V	15.0 lbs.	-
955079CX	Remanufactured WABCO SS1200 with Coalescing Filter	-	12V	15.0 lbs.	165WAB
955205	NEW WABCO SS1200	R955005 R955205	12V	15.0 lbs.	-
955205CX	Remanufactured WABCO SS1200 with Coalescing Filter	R9550630 R9550630X	12V	14.0 lbs.	165WAB4
955205K	NEW WABCO SS1200 with Pressure Controlled Check Valve	-	12V	14.5 lbs.	-
955205KRX	Remanufactured WABCO SS1200 with Pressure Controlled Check Valve	-	12V	14.5 lbs.	-
955205KX	Remanufactured WABCO SS1200 with Pressure Controlled Check Valve	-	12V	15.0 lbs.	165WAB
955205RX	Remanufactured WABCO SS1200	-	12V	15.0 lbs.	-
955205X	Remanufactured WABCO SS1200	R955005 R955205	12V	15.0 lbs.	165WAB
955206CX	Remanufactured WABCO SS1200 with Coalescing Filter	-	24V	11.1 lbs.	165WAB
955206KCX	Remanufactured WABCO SS1200 with Pressure Controlled Check Valve and Coalescing Filter	-	24V	15.0 lbs.	165WAB
955206X	Remanufactured WABCO SS1200	R955206	24V	11.1 lbs.	165WAB
955300CX	Remanufactured WABCO SS1200P with Coalescing Filter	-	12V	15.0 lbs.	166WAB
955300X	Remanufactured WABCO SS1200P	R955300	12V	15.0 lbs.	166WAB
955315CX	Remanufactured WABCO SS1200P with Coalescing Filter	-	24V	15.0 lbs.	166WAB
955315X	Remanufactured WABCO SS1200P	R955315	24V	15.0 lbs.	166WAB



## WABCO SS1200 Service Kits

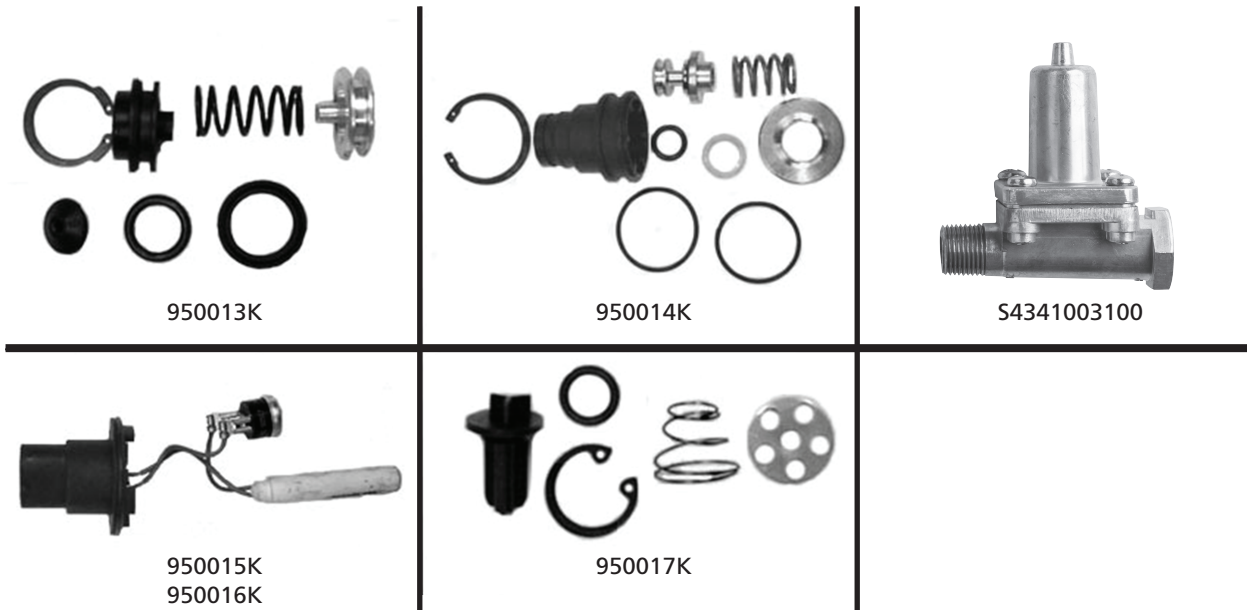

Service Part No.	Product Description	Application
950013K	Turbo Cut-Off Valve Kit - WABCO SS1200	955205X, 955206X
950014K	Purge Valve Kit - WABCO SS1200	955205X, 955206X
950015K	Heater Kit 12V - WABCO SS1200	955205X, 955206X
950016K	Heater Kit 24V - WABCO SS1200	955206X, 955315X
950017K	Outlet Check Valve Kit - WABCO SS1200	955205X, 955206X
S4341003100	Pressure Controlled Check Valve - WABCO SS1200	955205K, 955205KRX, 955205KX, 955206KCX

## Bendix® AD-2



**Features:**

- Desiccant type
- In-line filtration system
- Automatic drain valve which is controlled by the governor

**Specifications:**

Approximate Weight                      25.0 lbs.

**Notes:**

- 1) Air dryer not supplied with mounting bracket.
- 2) 286934X and 296936X are R&R only.

Service Part No.	Product Description	Heater Voltage	Inlet Port	Outlet Port	Plugged Port	Core Group
286934X	Remanufactured Bendix® AD-2	12V	1/2"	1/2"	1/2"	153AD2
286936X	Remanufactured Bendix® AD-2	24V	1/2"	1/2"	1/2"	153AD2

## Bendix® AD-4



**Features:**

- Desiccant type
- In-line filtration system
- Automatic drain valve which is controlled by the governor

**Specifications:**

Approximate Weight                      32.6 lbs.

**Notes:**

- 1) Air dryer not supplied with mounting bracket.

Service Part No.	Product Description	Heater Voltage	Heater Watts	Supply Port	Delivery Port	Control Port	Core Group
65041X	Remanufactured Bendix® AD-4	12V	60W	1/2"	1/2"	1/4"	154AD4

## Bendix® AD-9



### Features:

- Desiccant type
- In-line filtration system
- Automatic drain valve which is controlled by the governor

### Specifications:

Approximate Weight                      28.0 lbs.

Service Part No.	Product Description	Heater Voltage	Heater Watts	Supply Port	Delivery Port	Control Port	Notes	Core Group
109685CX	Reman. Bendix® AD-9 with Coalescing Filter	12V	75W	1/2" NPT	1/2" NPT	1/4" NPT	Replaces Bendix® 65225X	157AD9
109685HX	Reman. Bendix® AD-9	12V	75W	1/2" NPT	1/2" NPT	1/4" NPT	Includes wiring harness, mounting bracket. Replaces Bendix® 5009378.	157AD9
109685X	Reman. Bendix® AD-9	12V	75W	1/2" NPT	1/2" NPT	1/4" NPT	Replaces Bendix® 65225X	157AD9
109687X	Reman. Bendix® AD-9	12V	75W	3/4" NPT	1/2" NPT	1/4" NPT	Replaces Bendix® 65226	157AD9
109688HX	Reman. Bendix® AD-9	24V	75W	3/4" NPT	1/2" NPT	1/4" NPT	Extended Purge Volume	157AD9
109688X	Reman. Bendix® AD-9	24V	75W	3/4" NPT	1/2" NPT	1/4" NPT	Extended Purge Volume	157AD9
109689CX	Reman. Bendix® AD-9 with Coalescing Filter	12V	75W	1/2" NPT	1/2" NPT	1/4" NPT	Soft Seat	157AD9
109689X	Reman. Bendix® AD-9	12V	75W	1/2" NPT	1/2" NPT	1/4" NPT	Soft Seat	157AD9
65224	New Bendix® AD-9	24V	75W	1/2" NPT	1/2" NPT	1/4" NPT	Includes wiring harness, mounting bracket.	-
65224X	Reman. Bendix® AD-9	24V	75W	1/2" NPT	1/2" NPT	1/4" NPT	Does not include mounting bracket.	157AD9
65225	New Bendix® AD-9	12V	75W	1/2" NPT	1/2" NPT	1/4" NPT	Includes wiring harness and mounting bracket.	-
65228X	Reman. Bendix® AD-9	12V	75W	3/4" NPT	1/2" NPT	1/4" NPT	Extended Purge Volume	157AD9
65499X	Reman. Bendix® AD-9	12V	75W	1/2" NPT	1/2" NPT	1/4" NPT	Discharge Line Unloader (DLU)	157AD9
65605X	Reman. Bendix® AD-9	24V	75W	1/2" NPT	1/2" NPT	1/4" NPT	Discharge Line Unloader (DLU)	157AD9
65647WX	Reman. Bendix® AD-9	12V	75W	1/2" NPT	1/2" NPT	1/4" NPT	Drop In Holset® QE App. with port plugged	157AD9
65647X	Reman. Bendix® AD-9	12V	75W	1/2" NPT	1/2" NPT	1/4" NPT	Drop In Holset® QE App.	157AD9
65650	New Bendix® AD-9	12V	75W	1/2" NPT	1/2" NPT	1/4" NPT	Soft Seat. Includes wiring harness, mounting bracket.	-
65650N	New Bendix® AD-9	12V	75W	1/2" NPT	1/2" NPT	1/4" NPT	Soft Seat. Does not include wiring harness, mounting bracket	-

## Bendix® AD-IP



### Features:

- Desiccant type
- In-line filtration system
- Automatic drain valve which is controlled by the governor

### Specifications:

Height	12.5"
Width	9.25"

Service Part No.	Product Description	Heater Voltage	Supply Port	Delivery Port	Control Port	Approx. Weight	Notes	Core Group
109477CX	Reman. Bendix® AD-IP with Coalescing Filter	12V	1/2" NPT	1/2" NPT	1/4" NPT	26.2 lbs.	Does not include wiring harness, mounting bracket.	161ADIP
109477RX	Reman. Bendix® AD-IP	12V	1/2" NPT	1/2" NPT	1/4" NPT	26.2 lbs.	Corefree. Does not include wiring harness, mounting bracket.	-
109477X	Reman. Bendix® AD-IP	12V	1/2" NPT	1/2" NPT	1/4" NPT	26.2 lbs.	Does not include wiring harness, mounting bracket.	161ADIP
109478X	Reman. Bendix® AD-IP	24V	1/2" NPT	1/2" NPT	1/4" NPT	27.0 lbs.	Does not include wiring harness, mounting bracket.	161ADIP
5000709X	Reman. Bendix® AD-IP	12V	1/2" NPT	1/2" NPT	1/4" NPT	27.0 lbs.	Drop In unit for Cummins® Econ application.	161ADIP
5000985X	Reman. Bendix® AD-IP	12V	1/2" NPT	1/2" NPT	1/4" NPT	26.2 lbs.	With Econ port plugged	161ADIP
5018227X	Reman. Bendix® AD-IP	12V	1/2" NPT	1/2" NPT	1/4" NPT	26.2 lbs.	Discharge Line Unloader (DLU) style purge assembly	161ADIP

## Bendix® AD-IS



### Features:

- Desiccant type
- In-line filtration system
- Automatic drain valve which is controlled by the governor

### Specifications:

Approximate Weight                      15.0 lbs.

### Notes:

1) Used with tanks 26" and longer.

Service Part No.	Product Description	MFG Part No.	Heater Voltage	Heater Wattage	Supply Port	Delivery Port	Control Port	Core Group
5004050CX	Reman. Bendix® AD-IS with extra purge volume	5004050PG	12V	90W	1/4" NPT	1/4" NPT	1/4" NPT	168ADIS
5004050X	Reman. Bendix® AD-IS used on Dryer Reservoir Module (DRM™)	5004050	12V	90W	1/4" NPT	1/4" NPT	1/4" NPT	168ADIS
5010696CX	Reman. Bendix® AD-IS with extra purge volume and coalescing filter	5010696PG	12V	90W	1/4" NPT	1/4" NPT	1/4" NPT	168ADIS
5010696X	Reman. Bendix® AD-IS used on Dryer Reservoir Module (DRM™) with coalescing filter	5010696	12V	90W	1/4" NPT	1/4" NPT	1/4" NPT	168ADIS

## Bendix® AD-SP

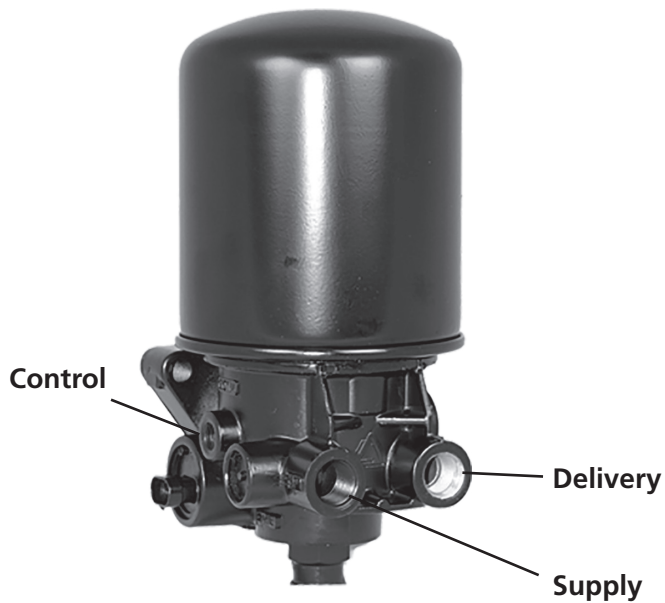

### Features:

- System Purge

### Specifications:

Height	11.07"
Width	5.62"

### Notes:

- 1) DO NOT remove rear cover, components under cover are not serviceable.

Service Part No.	Product Description	MFG Part No.	Heater Voltage	Heater Wattage	Supply Port	Delivery Port	Control Port	Approx. Weight	Core Group
109991	New Bendix® AD-SP	109991 065691	12V	90W	1/2" NPT	1/2" NPT	1/4" NPT	10.5 lbs.	-
109991CX	Reman. Bendix® AD-SP with coalescing filter	109991 065691	12V	90W	1/2" NPT	1/2" NPT	1/4" NPT	11.4 lbs.	164ADSP
109991X	Reman. Bendix® AD-SP	109991 065691	12V	90W	1/2" NPT	1/2" NPT	1/4" NPT	11.4 lbs.	164ADSP
109992CX	Reman. Bendix® AD-SP with coalescing filter	109992 065694	12V	90W	1/2" NPT	1/2" NPT	1/4" NPT	10.5 lbs.	164ADSP
109992X	Reman. Bendix® AD-SP	109992 065694	12V	90W	1/2" NPT	1/2" NPT	1/4" NPT	10.5 lbs.	164ADSP
800973CX	Reman. Bendix® AD-SP Drop In unit for Holset® QE application.	800973	12V	90W	1/2" NPT	1/2" NPT	1/4" NPT	12.0 lbs.	164ADSP
800973X	Reman. Bendix® AD-SP Drop In unit for Holset® QE application.	800973	12V	90W	1/2" NPT	1/2" NPT	1/4" NPT	12.0 lbs.	164ADSP

Bendix® End Cover Assembly

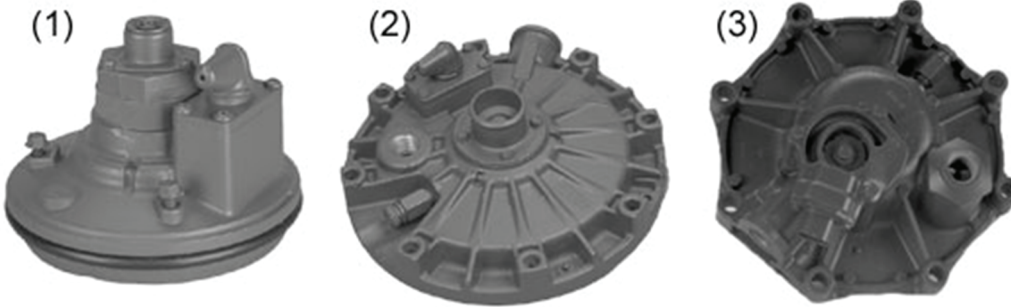

Service Part No.	Product Description	Voltage	Wattage	Supply Port	Delivery Port	Approx. Weight	Core Group	Pic. No.
103980K	Bendix® AD-4 End Cover Repair Kit	12V	-	1/2" NPT	1/2" NPT	6.3 lbs.	-	2
28675RX	Reman. Bendix® AD-2 End Cover Assembly - Corefree	12V	-	-	-	2.2 lbs.	-	1
286875X	Reman. Bendix® AD-2 End Cover Assembly	12V	-	-	-	2.2 lbs.	149AD2	1
286876X	Reman. Bendix® AD-2 End Cover Assembly	24V	-	-	-	2.2 lbs.	149AD2	1
65044X	Reman. Bendix® AD-4 End Cover Assembly	12V	-	1/2" NPT	1/2" NPT	6.3 lbs.	155AD4	2
65231X	Reman. Bendix® AD-9 End Cover Assembly	12V	75W	1/2" NPT	1/2" NPT	6.7 lbs.	160AD9	3
65454X	Reman. Bendix® AD-9 End Cover Assembly	24V	-	3/4" NPT	3/4" NPT	6.7 lbs.	160AD9	3
65654X	Reman. Bendix® AD-9 End Cover Assembly with Soft Seat Purge	12V	75W	1/2" NPT	1/2" NPT	6.7 lbs.	160AD9	3



## Bendix® Air Dryer Service Kits

**Notes:**

- 1) **5003547K, 5005037K, 5005893K** Purge Piston Retainer Shoulder Bolt not supplied. Must utilize old bolt when rebuilding purge valve assembly.

Service Part No.	Product Description	Application	Core Group
102657K	Thermostat - AD-2, AD-4 Air Dryer	286934X, 286936X, 65041X	-
103818K	Purge Valve Repair Kit - AD-4 Air Dryer	65041X	-
103879K	Check Valve/Seal Repair Kit - AD-4 Air Dryer	65041X	-
104027K	Mounting Bracket - AD-4 Air Dryer	65041X	-
107695K	Mounting Bracket - AD-9 Air Dryer	109685X, 109689X, 65224X	-
107798K	Purge Valve (Minor) Maintenance Kit - AD-9 Air Dryer	109685X, 109685HX, 65224X, 65647X	-
107800K	Check Valve Repair Kit - AD-9 Air Dryer	109685X, 109689X, 65224X	-
109494K	Delivery Check Valve Kit - AD-IP Air Dryer	109477X, 5000709X	-
109495K	12 Volt Heater and Thermostat - AD-IP, AD-IS Air Dryer	109477X, 5000709X	-
109498K	Cartridge Bolt Kit - AD-IP Air Dryer	109477X, 5000709X	-
109569K	Purge Valve and Heater/Thermostat Repair Kit - AD-9 (12V) Air Dryer	109685X	-
109578K	Heater and Thermostat Kit - AD-9 (12V) Air Dryer	109685X, 109689X	-
109579K	Heater and Thermostat Kit - AD-9 (24V) Air Dryer	65224X	-
109686X	Remanufactured Purge Valve and Heater/Thermostat Repair Kit - AD-9 (12V) Air Dryer	109685X	167AD9
109869K	Wire Harness and Connector Repair Kit - AD-9 Air Dryer	109685X, 109689X, 65224X	-
109871K	Wiring Harness and Splice Kit - AD-IP Air Dryer	109477X, 5000709X	-
109993K	Turbo Cutoff Kit - AD-SP Air Dryer	109991X, 109992X	-
109995K	Purge Valve Kit - AD-SP Air Dryer	109991X, 109992X	-
287053K	Purge Valve Repair Kit - AD-2 Air Dryer	286934X, 286936X	-
287298K	Check Valve Repair Kit - AD-2 Air Dryer	286934X, 286936X	-
5001247K	Mounting Bracket Kit - AD-IP Air Dryer	109477X, 5000709X	-
5003547K	Purge Valve Repair Kit - AD-IP Air Dryer	109477X, 5000709X, 5000985X SEE NOTES ABOVE	-
5004338K	Purge Valve and Heater/Thermostat Repair Kit AD-9 (24V) Air Dryer	65224X	-
5004341X	Remanufactured Purge Valve Assembly (Soft Seat Purge) with 12V Heater - AD-9 Air Dryer	109689X	167AD9
5004342X	Remanufactured Purge Valve Assembly (Soft Seat Purge) with 24V Heater - AD-9 Air Dryer	65605X	167AD9
5005037K	Purge Valve Maintenance Kit (Major Hard Seat) - AD-9 Air Dryer	109685X, 109685HX, 65224X, 65647X SEE NOTES ABOVE	-
5005893K	Purge Valve Maintenance Kit (Soft Seat) - AD-9 Air Dryer	109689X SEE NOTES ABOVE	-
800404K	Service Purge Valve - AD-IP, AD-IS Air Dryer	109477X, 5000709X	-
K022105K	Purge Valve Assembly Kit - Air Dryer	AD-IP/AD-IS (Dual U-Cup)	-

## Competitive Air Dryer Cartridges

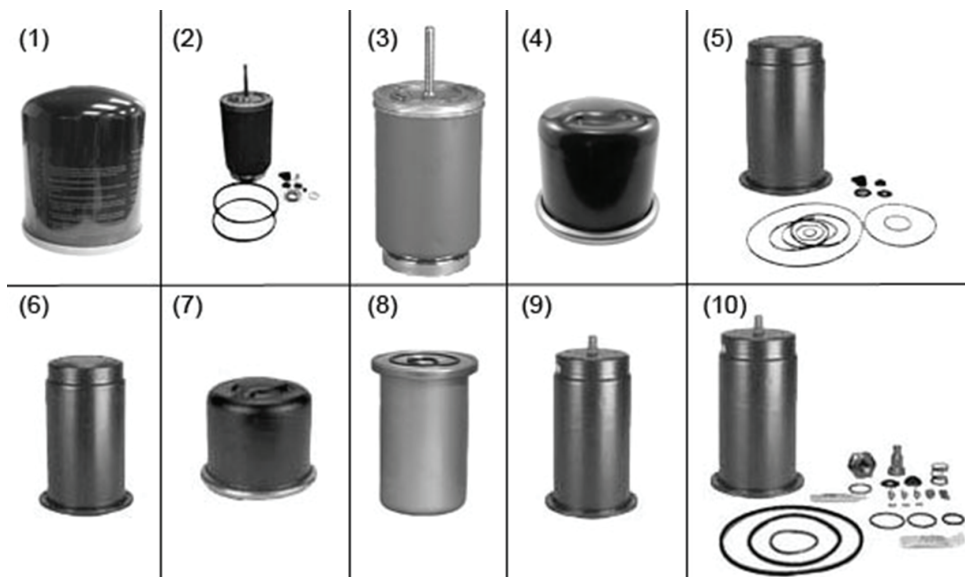

Service Part No.	Product Description	Application	Approx. Weight	Core Group	Pic. No.
031005609	New Haldex HFC Coalescing Cart.	AD-IS, AD-SP Air Dryer	7.9 lbs.	-	1
101900MKX	Desiccant Cartridge, Purge and Check Valve Kit	AD-2 Air Dryer	9.0 lbs.	148AD2	2
101900X	Remanufactured Desiccant Cartridge	AD-2 Air Dryer	7.8 lbs.	148AD2	3
104358MKX	Desiccant Cartridge, Purge and Check Valve Kit	AD-4 Air Dryer	10.4 lbs.	150AD4	5
104358X	Remanufactured Desiccant Cartridge	AD-4 Air Dryer	9.7 lbs.	150AD4	6
107794CX	Remanufactured Desiccant Cartridge with Coalescing Filter	AD-9 Air Dryer	10.7 lbs.	158AD9	9
107794MKX	Desiccant Cartridge, Purge and Check Valve Kit	AD-9 Air Dryer	10.7 lbs.	158AD9	10
107794RX	Remanufactured Bendix®0174 Desiccant Cartridge – Corefree	AD-9 Air Dryer	9.7 lbs.	-	9
107794X	Remanufactured Desiccant Cartridge	AD-9 Air Dryer	9.7 lbs.	158AD9	9
107796	New Desiccant Cartridge	AD-9 Air Dryer	9.7 lbs.	-	9
109493CX	Remanufactured Desiccant Cartridge with Coalescing Filter	AD-IP Air Dryer	15.9 lbs.	159ADIP	7
109493RX	Remanufactured Desiccant Cartridge Corefree	AD-IP Air Dryer	15.9 lbs.	-	7
109493X	Remanufactured Desiccant Cartridge	AD-IP Air Dryer	15.9 lbs.	159ADIP	7
109994K	New Desiccant Cartridge	AD-SP, AD-IS Air Dryer	6.6 lbs.	-	1
5008414K	New Desiccant Cartridge	AD-IS Air Dryer	7.0 lbs.	-	1
65624K	New Desiccant Cartridge	AP-IP Air Dryer	15.9 lbs.	-	4
950011K	New WABCO® Desiccant Cartridge	WABCO SS1200 Air Dryer	606 lbs.	-	1
CART224	New Chicago Rawhide® Desiccant Cartridge	C/R Turbo 2000 Air Dryer	9.9 lbs.	-	8

Haldex CONSEP® Condenser/Separator



Features:

- Removes oil, liquid and other contaminants prior to passage through the air system
- Purges contaminants with each brake application
- Reduces corrosion and possible failure of air system components caused by contamination
- Substantially increases air dryer desiccant life expectancy
- Includes Haldex Automatic Drain Valve

Specifications:

Weight	4.25 lbs.
Height	10.0"
Width	4.4"
Drain Capacity	1.3cc/purge @ 116 PSI
Mounting Position	Vertical
Max. Operating Pressure	290 PSI
Inlet Temperature	-40°F to 175°F
Port Sizes	1/2" - 14 NPTF
Rate Voltage and Power Consumption	24V/0.5 AMP or 12V/1 AMP

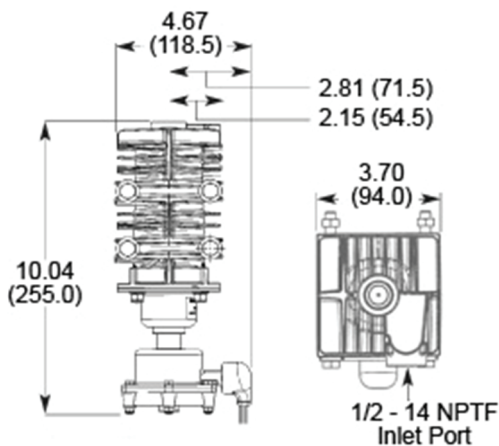

Service Part No.	Product Description	Heater Type
41210026	CONSEP® Condenser/Separator	12V
41210029	CONSEP® Condenser/Separator	24V

Haldex CONSEP® Condenser/Separator Service Kits



41277322



41290364



41092749  
41092750

Service Part No.	Product Description	Notes	Application
41092749	Automatic Drain Valve (ADV) for CONSEP® Condenser/Separator	Complete ADV for 24V CONSEP®	41210029
41092750	Automatic Drain Valve (ADV) for CONSEP® Condenser/Separator	Complete ADV for 12V CONSEP®	41210026
41277322	Condenser Kit for CONSEP® Condenser/Separator	Includes o-rings and plastic insert for condenser only	41210026 41210029
41290364	Seal Kit for CONSEP® Condenser/Separator	Includes washer, o-rings, hardware and internal components	41210026 41210029

Haldex Drain Tube Kit for CONSEP® or ADV



Service Part No.	Product Description	Side Outlet	Replaces	OEM Part No.
41178240	Drain Tube Kit for Automatic Drain Valve (ADV) or CONSEP® Condenser/Separator	3/4"	Bottom Cover	411-78240

# Haldex Automatic Drain Valve (ADV)



**Features:**

- Expels moisture with each brake application
- Reduces possible build-up of harmful condensation and contaminants
- Purge function is not dependent on compressor cycling
- Built-in heater, standard on all valves, prevents valve freeze-ups
- Built-in filter, standard on all valves, protects valve against contamination

**Specifications:**

Weight	1.4 lbs.
Height	2.1"
Width	4.4"
Drain Capacity	1.3cc/purge @ 11.8 PSI
Mounting Position	Vertical
Max. Operating Pressure	300 PSI
Rate Voltage and Power Consumption	24V/0.5 AMP or 12V/1 AMP

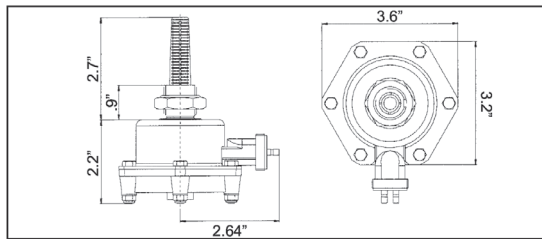

**Notes:**

- 1) Optional relay switch and 90° fitting are included with each valve.

Service Part No.	Product Description	Heater Type
41010019	Automatic Drain Valve (ADV) 12V	12V
41010021	Automatic Drain Valve (ADV) 24V	24V

# Haldex Automatic Drain Valve Service Kits



Service Part No.	Product Description	Application
41071327	Repair Kit for Automatic Drain Valve (ADV)	12V and 24V ADVs
41176281	Relay for Automatic Drain Valve (ADV)	24V ADVs
41176282	Relay for Automatic Drain Valve (ADV)	12V ADVs
41189454	Coil Repair Kit for Automatic Drain Valve (ADV)	24V ADVs
41189455	Coil Repair Kit for Automatic Drain Valve (ADV)	12V ADVs

## Haldex Reservoir Purge Valve (RPV)

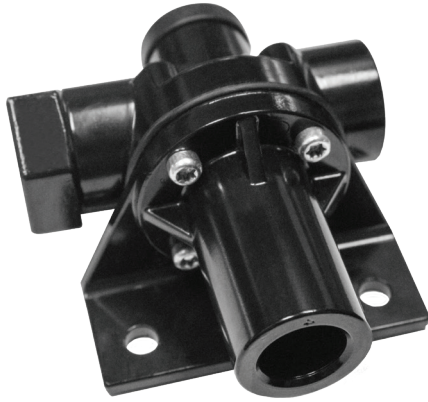

**Features:**

- Automatically purges water and other contaminants from reservoirs when vehicle is placed into park
- Filter design protects valve from debris and is easy to service without removing the valve from the vehicle
- Purge function is not dependent on compressor cycling
- Maintains reservoir pressure for quick system recharge after park brakes are released
- Can be retrofitted to existing equipment

**Specifications:**

Weight	1.3 lbs.
Operating Temp. Range	-40°F to 180°F (-40°C to 82°C)
Max. System Pressure	150 PSI

Service Part No.	Product Description	Notes
KN21200	Reservoir Purge Valve (RPV)	3 Year/350,000 Mile Warranty
42123048	Reservoir Purge Valve (RPV) Retrofit Kit	Kit Contents: Reservoir Purge Valve and Bracket; PTC Fitting 90° 3/8" NPT; PTC Fitting Straight 3/8" NPT; PTC Tee 3/8" NPT; PTC Tee 1/2" NPT; Branch Tee 1/4" NPT; Lock Nuts, Cap Screws, Washers, Installation Instructions

## Haldex Alcohol Evaporator



**Features:**

- The alcohol evaporator is an automatic vaporizing device for keeping airlines and air reservoir free of ice
- Pressure protected

**Notes:**

- 1) During the antifreeze season, before reactivating the evaporator, drain, disassemble, inspect and clean the unit of sludge. Steam cleaning will not injure the unit.
- 2) For optimum use of alcohol mount unit 8 to 10 feet from compressor and after air dryer if so equipped.

Service Part No.	Product Description	Capacity	Ports	Bracket Location	OEM Part No.
A72420	Alcohol Evaporator with Safety Valve	40 oz. of Methyl Alcohol	1/2" NPT	As shown in picture	AE72420
A72421	Alcohol Evaporator with Safety Valve	40 oz. of Methyl Alcohol	1/2" NPT	Opposite side of location shown in picture	AE72421
A72422	Alcohol Evaporator with Safety Valve	40 oz. of Methyl Alcohol	1/2" NPT	Both sides	AE72422
Service Kits					
A39219	Repair Kit to replace rubber parts	-	-	-	-
A48373	Tetraseal	-	-	-	AD48373
A75962	Safety Valve Only	-	-	-	AD75962
AE73494	Cover	-	-	-	AE73494

A hundred years.  
Three brands.  
One goal.

A world of safer vehicles

**MIDLAND**  
**Haldex**  
**Like-Nu**

**Haldex**



# Double duty.

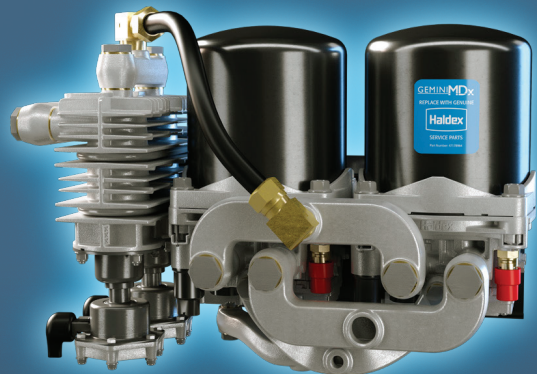

The GeminiMDx® air dryer system was built for transit and vocational braking. GeminiMDx doubles air treatment capacity while purifying brake system air to protect parts from corrosion and damage.

The rugged manifold design of the GeminiMDx delivers low initial and lifecycle costs and eliminates weight, trouble and complexity. Built-in components improve reliability and economy. And flexible Haldex design cuts service hours.

Ask your Haldex sales professional about GeminiMDx.

**Haldex**

[haldex.com](http://haldex.com)

High capacity, low cost, reliable performance and the cleanest air of any dual treatment system **GEMINI<sup>MDx</sup>**



With more than 100 years of intensely focused innovation, Haldex holds unrivaled expertise in brake systems and air suspension systems for heavy trucks, trailers and buses. We live and breathe our business, delivering robust, technically superior solutions born from deep insight into our customers' reality.

By concentrating on our core competencies and following our strengths and passions, we combine both the operating speed and flexibility required by the market. Collaborative innovation is not only the essence of our products - it is also our philosophy. Our employees, spread on four continents, are constantly challenging the conventional and strive to ensure that the products we deliver create unique value for our customers and all end-users.

To learn more, contact your Haldex sales professional.

United States 816-891-2470  
Canada 519-621-6722  
Mexico 52-81-81569500

For additional contact information  
or to learn more about Haldex,  
please visit [Haldex.com](http://Haldex.com)

**L00151**  
US Rev. 6/19 5M LS  
Printed In The USA